



**SSAS02451R**  
**DI.PA. SPORT REMANUFACTURED FRONT AIR STRUT**  
**FOR 2007-2012**  
**MERCEDES-BENZ GL-CLASS (W/O ADS)**



**WARNING:** *The air suspension system is under pressure (up to 10 bar, or 150 lbf/in). Verify pressure has been relieved and disconnect power to the air suspension system prior to disassembly. Do not allow dirt or grease to enter the system. Always wear standard hand, ear, and eye protection when servicing the air suspension system.*



**SSAS02451R**  
**DI.PA. SPORT REMANUFACTURED FRONT AIR STRUT**  
**FOR 2007-2012**  
**MERCEDES-BENZ GL-CLASS (W/O ADS)**

**GENERAL INFORMATION:**

- Not to be stored below 5°F (-15°C) and above 122°F (50°C).
- Avoid damage to air lines and cables.
- Removal and installation is only to be performed by fully qualified personnel.
- Use car manufacturer's diagnostic software.

**CAUTION:** *Damage to the vehicle and air suspension system can be incurred if work is carried out in a manner other than specified in the instructions or in a different sequence.*



*To avoid the possibility of short circuits while working with electric components consult your owner's manual on how to disconnect your battery.*



*Consult your vehicle owner's manual, service manual, or car dealer for the correct jacking points on your vehicle and for additional care, safety and maintenance instructions. Under no circumstances should any work be completed underneath the vehicle if it is not adequately supported, as serious injuries and death can occur.*

**AIR STRUT REMOVAL**

1. SET STEERING TO STRAIGHT AHEAD.
2. RAISE VEHICLE.
3. REMOVE FRONT WHEEL.
4. DISCONNECT THE SWAY BAR LINKAGE. (FIGURE A)



FIGURE A



**SSAS02451R**  
**DI.PA. SPORT REMANUFACTURED FRONT AIR STRUT**  
**FOR 2007-2012**  
**MERCEDES-BENZ GL-CLASS (W/O ADS)**

5. REMOVE THE NUT FROM THE BALL JOINT AND SEPARATE FROM THE SPINDLE ASSEMBLY. (FIGURE B)



FIGURE B

6. CLIP/CUT ZIP TIE FROM WIRE HARNESS MOUNT, THEN REMOVE THE WIRE HARNESS MOUNT FROM SHOCK. (FIGURE C)



FIGURE C

7. DISCONNECT THE AIR LINE. (FIGURE D)



FIGURE D



**SSAS02451R**  
**DI.PA. SPORT REMANUFACTURED FRONT AIR STRUT**  
**FOR 2007-2012**  
**MERCEDES-BENZ GL-CLASS (W/O ADS)**

8. REMOVE THE THREE (3) SHOCK TOP FLANGE NUTS. (FIGURE E)

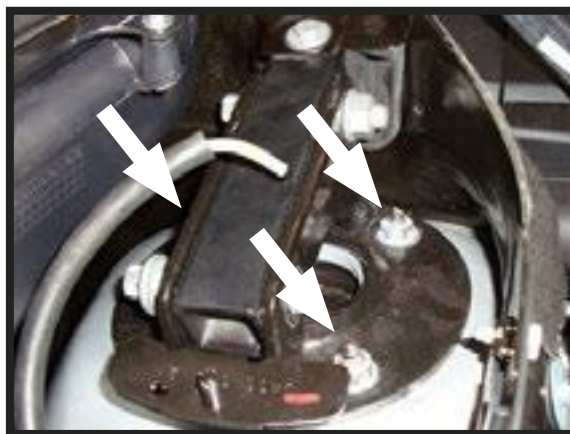

FIGURE E

9. REMOVE THE LOWER SHOCK MOUNT BOLT AND REMOVE THE STRUT FROM THE CAR. (FIGURE F)



FIGURE F

## **AIR STRUT INSTALLATION**



*Tighten all nuts and bolts to manufacturer's specifications during the installation process.*



*Do not remove the air fitting from the air strut. Doing so may cause damage and/or void warranty. Remove the white shipping pin from the new air fitting and insert the air line until fully seated.*



**SSAS02451R**  
**DI.PA. SPORT REMANUFACTURED FRONT AIR STRUT**  
**FOR 2007-2012**  
**MERCEDES-BENZ GL-CLASS (W/O ADS)**

1. REMOVE THE AIR LINE FITTING. TO DO THIS REMOVE THE COLLET AND THE REMAINING FITTING WILL SLIDE OFF OF AIR HOSE. (FIGURE G)

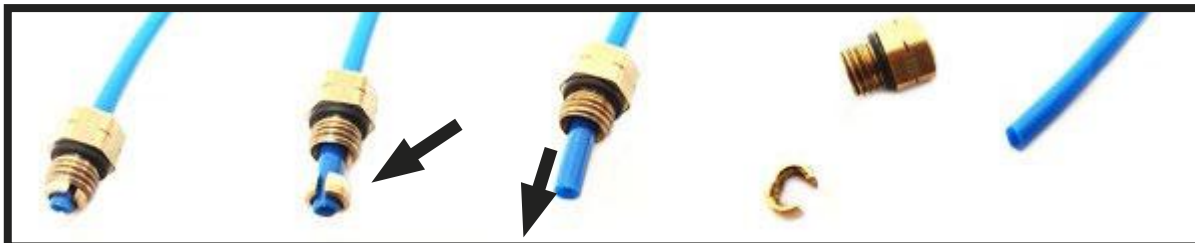

FIGURE G

2. CONTINUE INSTALLATION IN REVERSE ORDER OF AIR STRUT REMOVAL.
3. REMOVE THE PLASTIC PIN FROM THE AIR INLET FITTING, PUSH THE AIR HOSE IN UNTIL IT "LOCKS" IN PLACE (AIR LINE WILL NOT PULL OUT WHEN INSERTED PROPERLY). (FIGURE H)



FIGURE H

4. USING A CABLE TIE, SECURE THE WIRE HARNESS MOUNT TO THE SHOCK. (FIGURE I)



FIGURE I

5. INSTALLATION COMPLETE.